

Underbench units

Underbench unit on plinth

Intended use

- For storing equipment and chemicals in acc. with EN 14727
- For working heights of 750 mm and 900 mm
- Not suitable for storing flammable liquids, gas cylinders and self-igniting or self-decomposing substances
- Not suitable for storing acids and alkalis

Design

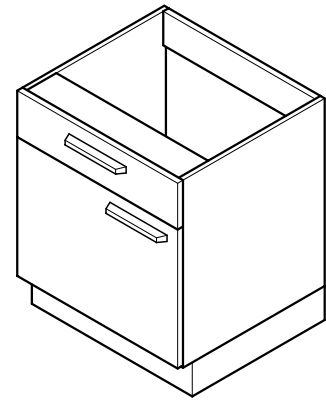

Variants

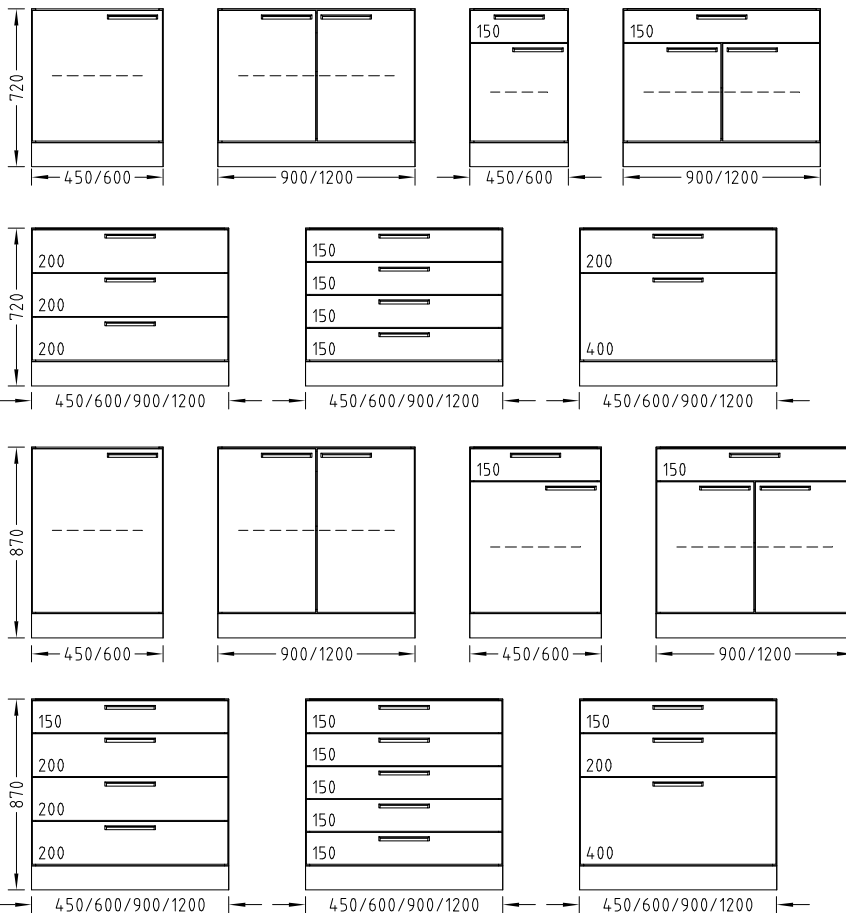

Underbench units

Underbench unit on plinth

Technical data

Dimensions				
Width [mm]	450	600	900	1200
Depth [mm]	550			
Overall height [mm]	720 870			
Height, drawers [mm]	150 200 400 Combination possibilities see variants			
Height, plinth [mm]	110			

Load bearing capacity	
Per shelf/drawer [kg]	30

Design characteristics	
Construction	For working height 750 and 900 mm Hinged doors with 270° hinges Drawers, fully extensible Open at the top, rear panel can be removed Shelf, height-adjustable Without doors as a rack 4 height-adjustable feet
Combination possibilities	See variants
Handle	Handle bar <i>SCALA</i> U handle, stainless steel
Drawers with change-pull-out catch	Optional
Full-height drawers	Optional
Soft stop for drawer	Optional
Extract air spigot	Optional
Closing	Optional